



90 and 120kVA Diesel Engine Driven GPU Deutz Diesel



Note: Shown with optional Transformer-Rectifier pack for 28.5VDC

HOBART: “A NAME YOU CAN TRUST”

Hobart offers the best combination of superior design, performance, proven reliability, and value to meet the critical needs of the airline industry with our series of modern ground power units. Integrating the *best in technology, customer influenced design* and Hobart’s years of *engineering expertise*, our Ground Power Units can be trusted to meet your aircraft’s needs for quality 400Hz power.

DESIGNED FOR DURABILITY:

Low profile, combined with standard 5th wheel (turntable) steering, provides superior visibility and maneuverability in congested ramp areas, while the durable bumper system protects the unit from damage caused by other GSE.

POWER FOR PEAK PERFORMANCE:

The Hobart Deutz diesel powered GPU’s feature the BF6M1013EC electronically controlled diesel engine, combined with a *Hobart designed and manufactured generator*, to maximize GPU performance while maintaining the traditional Hobart reputation of longevity and durability.

CE and EMISSION CERTIFIED:

Hobart teamed with Deutz Corp. to specify the most technically advanced engine designed to meet both current and future Emission Standards. CE Certification and international labeling is an added feature of this GPU.

PERFORMANCE FEATURES

- Fully Emission Certified Engine
- Noise “Isonorized” design with optional noise reduction kit
- Large stainless steel fuel tank and low fuel warning are **standard**
- Delayed stop (for turbo protection) and emergency shutdown are **standard**
- Hobart-designed and manufactured generator offers long life and reliability
- Racor® fuel/water separator is **standard**
- Numbered, color-coded wiring remains traceable for the life of the unit
- 5th wheel (turntable) steering features maintenance-free nylon bushings
- Choice of drum type braking systems: tow bar activated or hand brake activated
- Superior regulation via electronic controlled engine
- Lift-off doors and pop-out panels provide easy access to engine, generator and control compartments

Model	KV	KW	Outputs	Engine Model	HP	Unit Weight
90DZ20	90	72	1 or 2	BF6M1013EC	215	6900 lbs. (3130 kg)
120DZ20	120	96	2	BF6M1013EC	215	6900 lbs. (3130 kg)

Hobart is an ISO9001 Certified Manufacturer

Hobart Deutz Diesel Engine Driven Ground Power Unit

Specifications

Engine

- Deutz BF6M1013EC diesel operating at 2000 RPM (215 hp)
- Turbocharged 4-stroke, inline 6 cylinder, charge air cooled
- Full application approval by Deutz Corp.
- 12VDC battery system
- Low oil pressure shutdown
- High coolant temperature shutdown
- Intake air restriction indication
- Cold weather grid heater

Environmental

- Operation temperature:
-25° F to +125° F
-31° C to +52° C
- Relative humidity 0-100% noncondensing
- No altitude derating required up to 10,000 feet, when running in normal operating range

Performance

- Rating: 90 or 120 kVA, 3 phase, 4 wire, 115/200 volt Wye, continuous
- Meets or exceeds MIL-STD-704E Electrical Power Quality Requirements

Overload

- 125% rated load for 5 minutes, 150% for 10 seconds
- Individual outputs: 324 amps, 5 minutes

Voltage

- Transient voltage recovery time: to within $\pm 1\%$ in 100 milliseconds (no load to rated load)
- Within $\pm 20\%$ deviation upon application/removal of 100% load rating
- Modulation: does not exceed 0.5% of steady state voltage
- Phase voltage displacement with balanced load: 120 ± 1.5
- Phase voltage balance (with unbalanced load) does not exceed 4% with 1/3 rated current on any single phase with other two phases disconnected

- Crest factor: 1.404 ± 0.07
- Individual Harmonic Distortion: $< 2\%$ of the fundamental (RMS) voltage
- Total Harmonic Distortion: $< 3\%$ of the fundamental (RMS) voltage

Regulation

- Voltage Regulation: $\pm 1\%$ no load to full load
- Voltage adjust: ± 15 volts
- IHD (individual harmonic content): $< 2\%$
- Three phase average sensing, built-in line drop compensation, up to 5%
- Line Drop Compensation: Automatic up to 5%

Frequency

- Regulation: ± 2 Hz steady state
- Transient recovery: to within ± 5 Hz in < 2 seconds per ARP 5015A
- Modulation: $< 0.25\%$ (1Hz)

Protection

- Meets MIL-STD-704E
- Overvoltage: instantaneous disconnect of load at 180 volts L-N, with inverse time delay down to 126 volts in 2 seconds
- Undervoltage: disconnects output below 100 volts L-N in 7 seconds
- Overfrequency: disconnects output above 420Hz in 5 seconds
- Underfrequency: disconnects output below 370Hz in 7 seconds

Finish

- Anti-corrosive primer and Polyester powder provides excellent weather resistance, flexibility and adhesion, plus a strong resistance to chemical agents such as glycol and skydrol
- Standard colors are high gloss white over black frame and chassis
- Custom colors require a paint chip or swatch for accurate color match

Displays / Instrumentation

Engine Operation

- **Meters:** coolant temperature, ammeter, hour meter, oil pressure, fuel level
- **Indicator lights:** engine circuit on, air cleaner restriction, high coolant temperature, low oil pressure, engine stop delay action, low fuel
- **Switches:** Engine start, engine stop, panel lights, grid heater
- Delayed shutdown for turbocharger protection

Generator Output

- **Meters:** frequency, ammeter, voltmeter
- **Indicator Lights:** contactors on, overfrequency, underfrequency, overload, overvoltage, undervoltage, EF bypass
- **Switches:** meter select, output contactors control, test/reset

Trailer

- Tire size: 20.5 x 8.00 - 10
- Ground clearance: 9" (.23m)
- Brakes: Tow bar activated, drum type

Available Options:

- Block heater kit (120V/60Hz or 240V/50Hz)
- External Transformer-Rectifier pack for 28.5VDC
- Automatic towbar height stop
- Pintle or pin hitch
- Spot light
- Alternative mounting configuration: stationary/ fixed or truck mounted
- Special paint scheme
- Hand activated brakes
- Battery blanket (120V)
- Indicator beacons (low fuel, operating)
- Second output (90kVA model)
- Noise reduction kit

Specifications subject to change without notice.

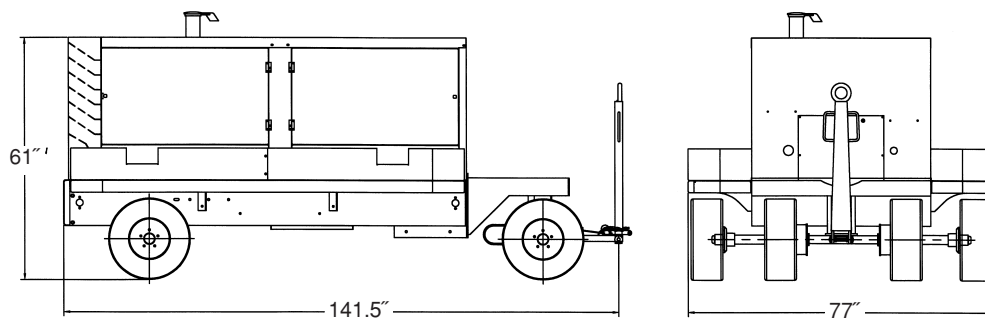

Hobart Ground Power • Headquarters & Factory: 1177 Trade Road East, Troy, OH 45373 U.S.A.
Phone: 1-800-422-7253 or 937-332-5080 • Fax: 937-332-5799
E-mail: hgpsales@itwgsegroup.com • www.hobartgroundpower.com

Hobart Beijing Office • Phone: 86 (0) 10-68561385/6/7 • Fax: 86 (0) 10 68561389

Hobart International (UK) • Phone: 44-1723-370437 • Fax: 44-1723-370125

ITW **GS GROUP**

